

# Spoke type load cell



## Features

Capacity 2t, 5t, 10t

High accuracy

High stability

Nickel plated alloy steel

## Optional features

Stainless steel construction

## DESCRIPTION

The ZMLBA is high precision spoke type load cell designed for both tension and compression force measurement. Nickel plated alloy steel can make protection class achieve IP67. The load cell is suitable for testing machines and special measuring equipment. Stainless steel construction is optional.

## DIMENSIONS (mm)

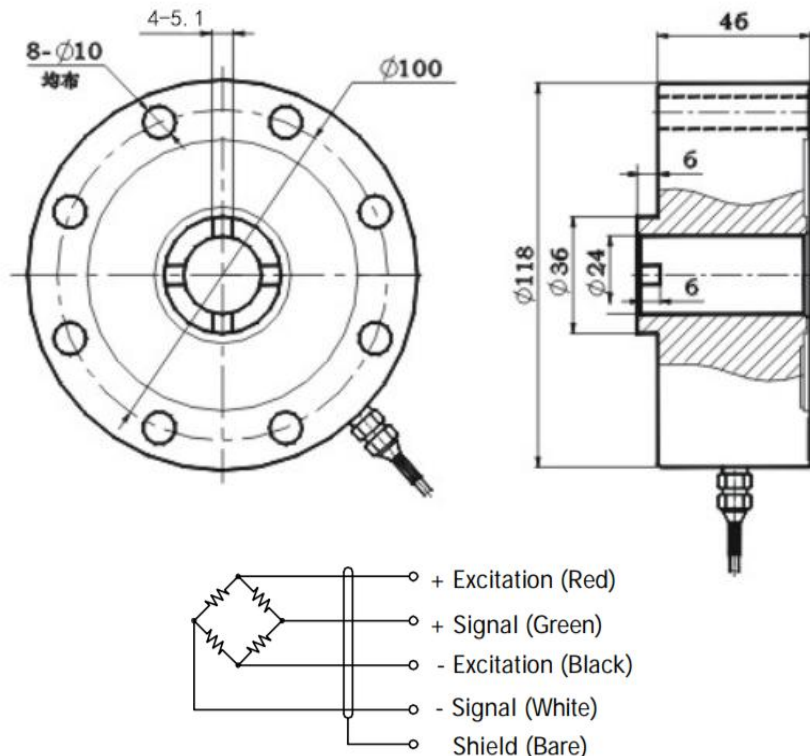

## SPECIFICATIONS

PARAMETER	VALUE	UNIT
Standard capacities (E <sub>max</sub> )	2,5,10	T
Rated output-R.O.	2.0	mV/V
Zero balance	1	±% of rated output
Non linearity	0.03	±% of rated output
Hysteresis	0.03	±% of rated output
Non-repeatability	0.02	±% of rated output
Creep error (30 minutes)	0.03	±% of rated output
Zero return (30 minutes)	0.03	±% of rated output
Temperature effect on min. dead load output	0.0026	±% of rated output/°C
Temperature effect on sensitivity	0.0015	±% of rated output/°C
Compensated temperature range	-10 to +40	°C
Operating temperature range	-20 to +60	°C
Safe overload	150	% of R.C
Ultimate overload	200	% of R.C
Excitation, recommended	10	Vdc
Excitation, maximum	15	Vdc
Input resistance	720±20	Ohms
Output resistance	700±3	Ohms
Insulation resistance	5000	Mega-Ohms
Material	Alloy steel	
Protection class	IP67	

All specifications listed subject to change without notice.