

# Double ended beam load cell



## Features

Capacity 1Klb-50Klb

High accuracy

High stability

Nickel plated alloy steel

## Optional features

Stainless steel construction

## DESCRIPTION

The ZMHB double-ended mounting provides good restraint to possible movement of the tanks and, in many cases, eliminates the needs for check rods. The shear beam design gives excellent performance for high capacity loading. The ZMHB is constructed of alloy steel and is potted to IP67 providing excellent protection against moisture and humidity.

## DIMENSIONS (mm)

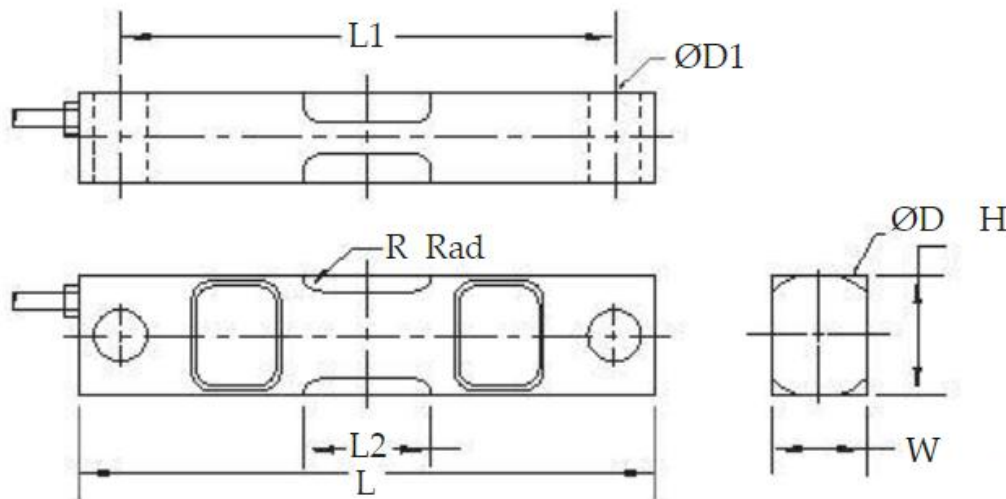

Capacity	L	L1	L2	W	H	D	D1	R
1Klb-5Klb	190.5	158.8	35.4	31.7	31.7	31.7	12.7	5
10Klb-50Klb	342.9	292.1	82.6	62	74.7	76.2	33.3	5

## SPECIFICATIONS

PARAMETER	VALUE	UNIT
Standard capacities (E <sub>max</sub> )	1K-50K	lb
Rated output-R.O.	2.0	mV/V
Zero balance	1	±% of rated output
Non linearity	0.03	±% of rated output
Hysteresis	0.03	±% of rated output
Non-repeatability	0.02	±% of rated output
Creep error (30 minutes)	0.03	±% of rated output
Zero return (30 minutes)	0.03	±% of rated output
Temperature effect on min. dead load output	0.0026	±% of rated output/°C
Temperature effect on sensitivity	0.0015	±% of rated output/°C
Compensated temperature range	-10 to +40	°C
Operating temperature range	-20 to +60	°C
Safe overload	150	% of R.C
Ultimate overload	200	% of R.C
Excitation, recommended	10	Vdc
Excitation, maximum	15	Vdc
Input resistance	720±20	Ohms
Output resistance	700±3	Ohms
Insulation resistance	5000	Mega-Ohms
Material	Alloy steel	
Protection class	IP67	

All specifications listed subject to change without notice.